

Barre d'appui droite

Tube Ø 30 mm

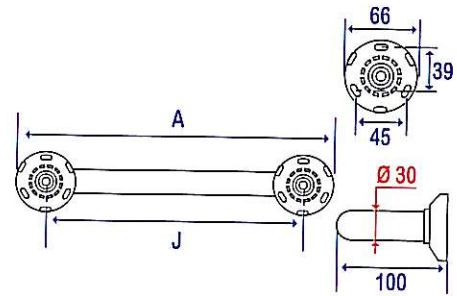

C A= 366 mm J= 300 mm

049530

C A= 566 mm J= 500 mm

049550

S A= 866 mm J= 800 mm

049580

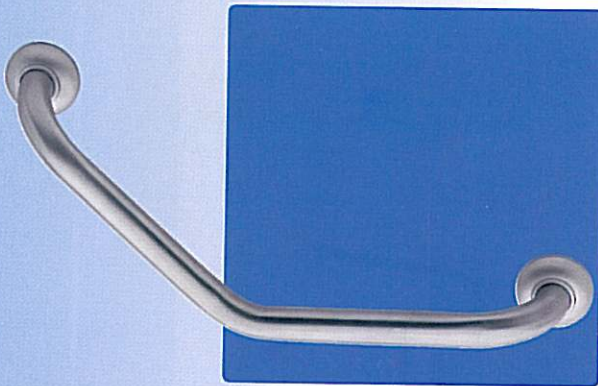

Barre d'appui coudée

Angle 135° symétrique 265 x 265 mm
Tube Ø 30 mm

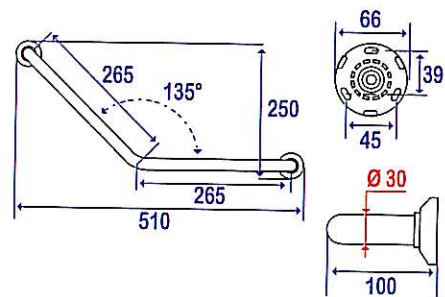

C

049630

new

Barre d'appui coudée

Angle 135° symétrique 400 x 400 mm
Tube Ø 30 mm

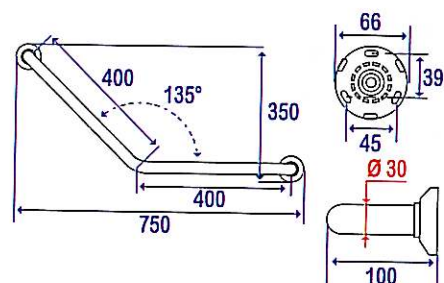

S

049640

